

NOTE: THIS DRAWING IS PRELIMINARY. PLEASE REFER TO THE CERTIFIED BLUEPRINT FOR FINAL DIMENSIONS.

Horizontal Distance	Inside Clearance
1'	8'-6"
2'	9'-4.5"
3'	9'-10.5"
4'	10'-3"
5'	10'-5"

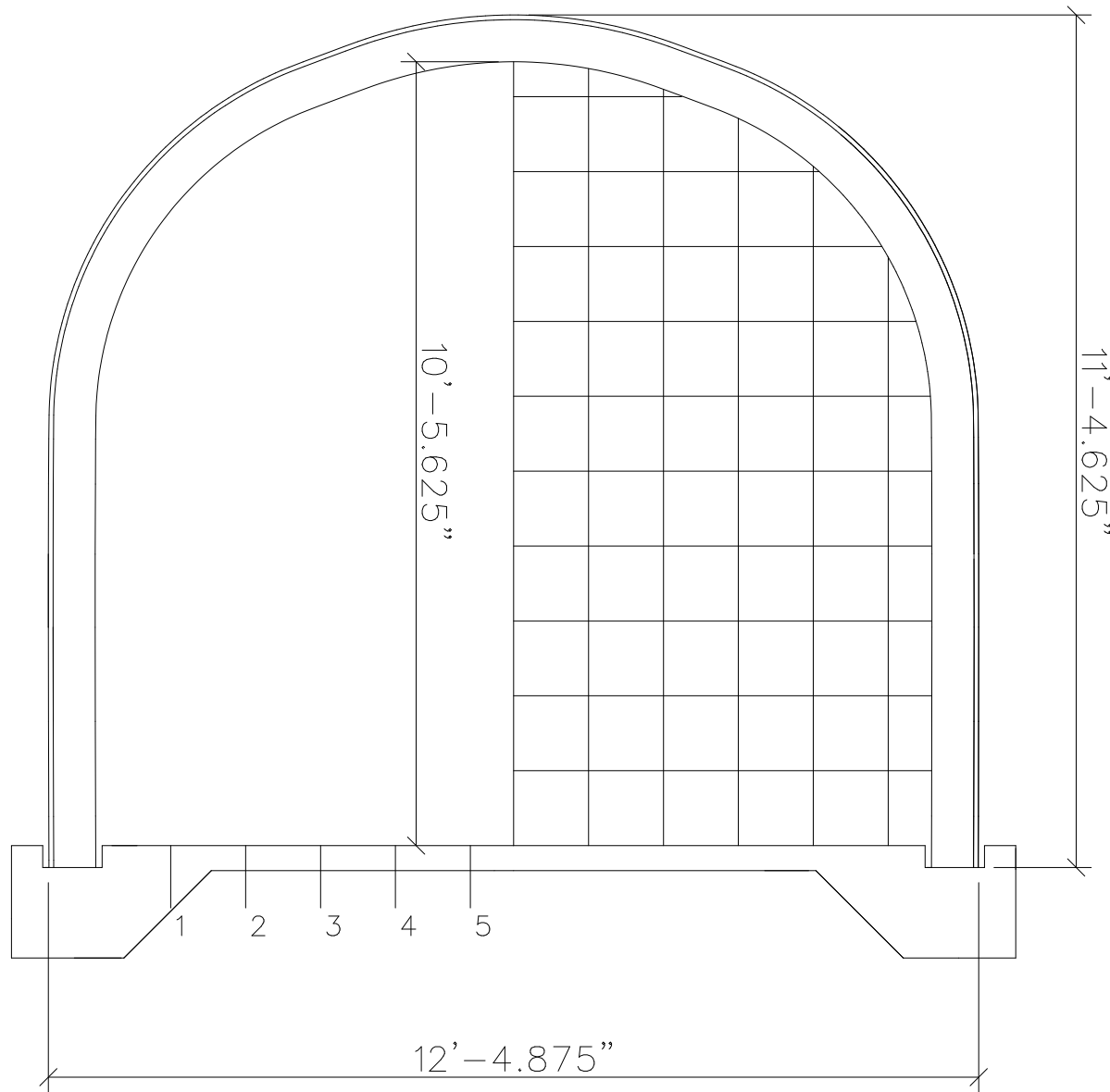

Standard 120" panels: 0	1 short panel: 71.44	bolts/arch: 102	Date: 10/4/2022
2 eave panels: 92.25	str. wall panels: 2@71.44		
Endwall area, sq.ft: 126.25	Volume/ft, cu.ft: 121.63	Surface area/arch, sq.ft: 76.10	Total arch length: 362.87

